

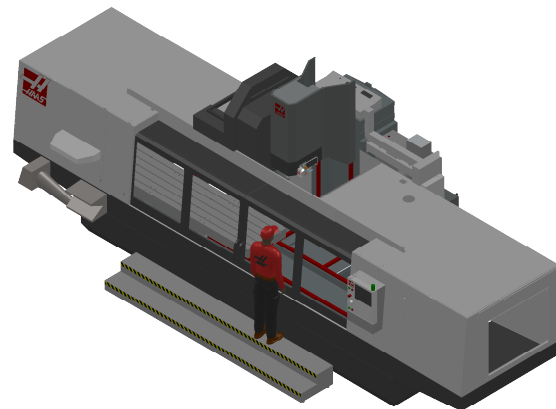

Installed Dimensions

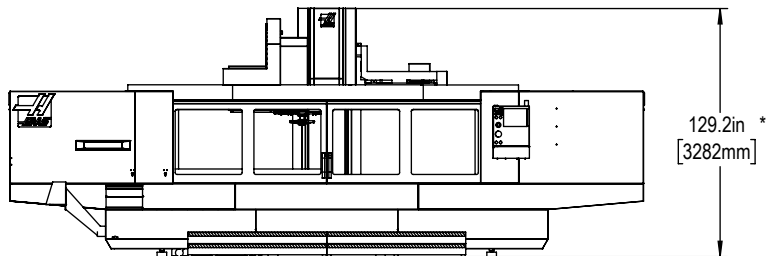

NOTE: 8" EXTENDED Z-AXIS CLEARANCE OPTION ADDS 8" (203mm) TO DIMENSIONS WITH *

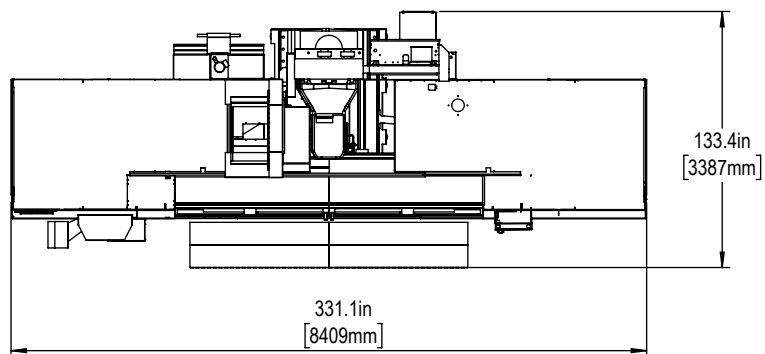

Leveling Pad Height

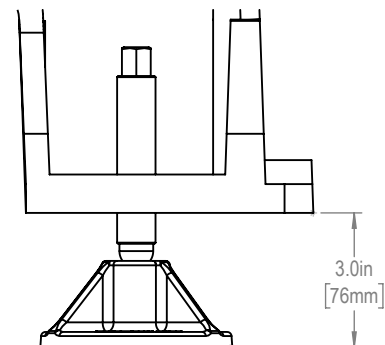

*All Height Dimensions Based on Suggested Leveling Pad Height

Shipping Dimensions

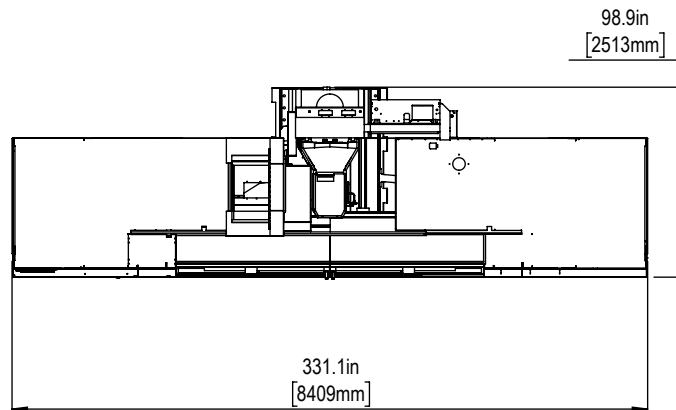
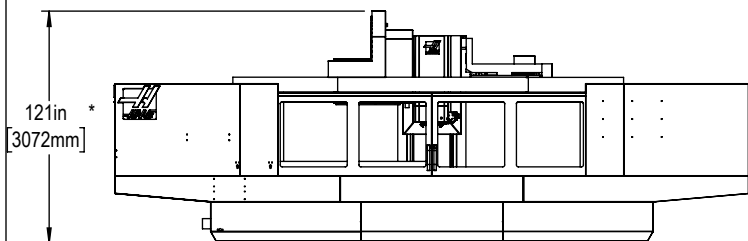

Air & Power

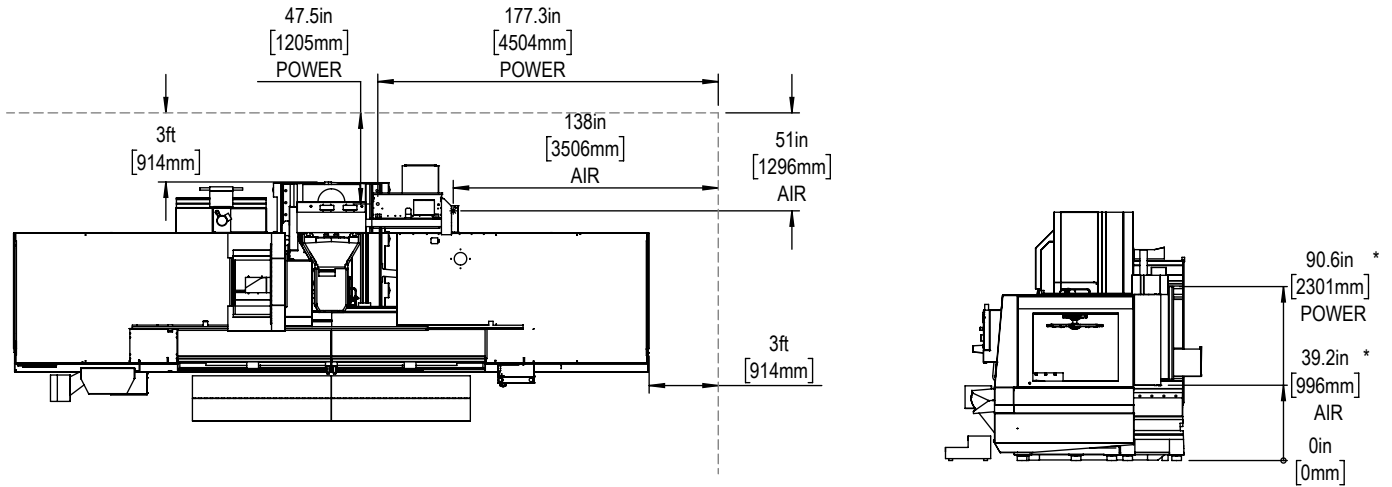

Maintain 3 feet [915mm] clearance to the nearest obstruction around all sides of machine perimeter for maintenance access

Note:
Machine must be placed on one continous concrete slab. Slab should extend 12in [305mm] beyond anchor holes in all directions

Anchor Pattern

For machines built before Sept. 2023

Anchor Hole Detail
 Ø 1.0in[25mm]
 ∇ 2.0in[51mm]-
 ∇ 2.5in[64mm]

NOTE: For machines built after Sept. 2023, see separate Anchoring Template.

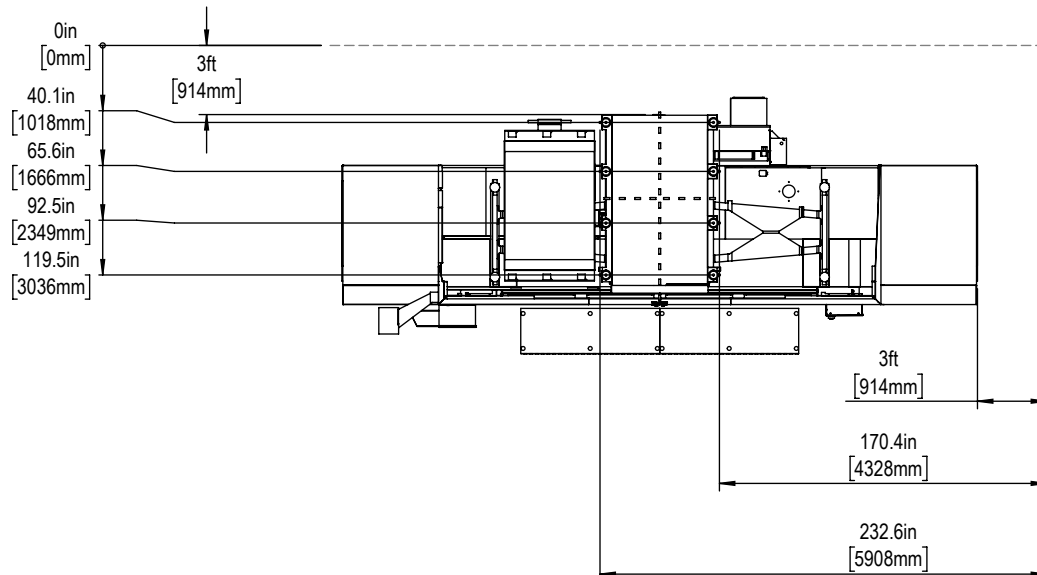

For precise locations and specifications please use template in Anchoring Kit found at Haascnc.com



Height Breakdown

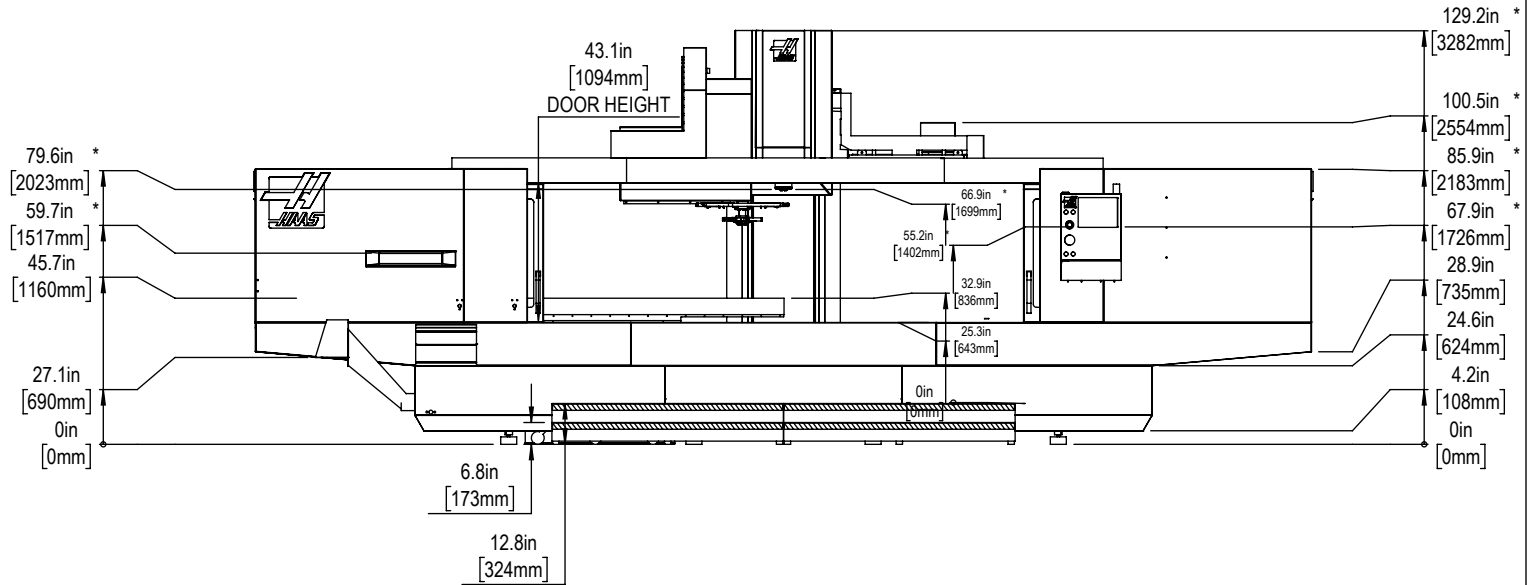

Width Breakdown

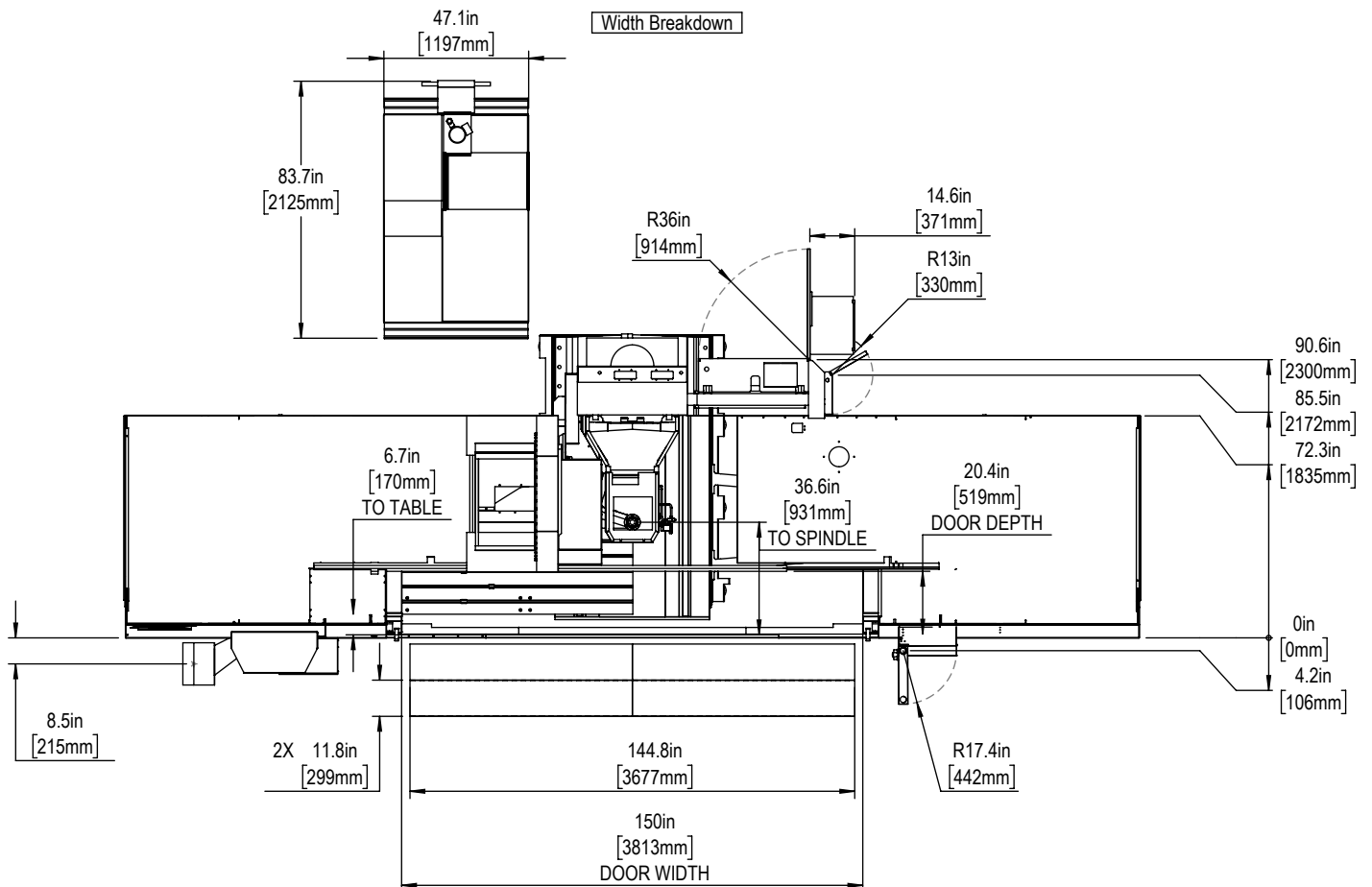

All dimensions based on stackup of sheetmetal, subject to variation of 1/2" (13mm) Due to continual product improvements, dimensions are subject to change without notice

X&Y-Axis Travel and Clearance

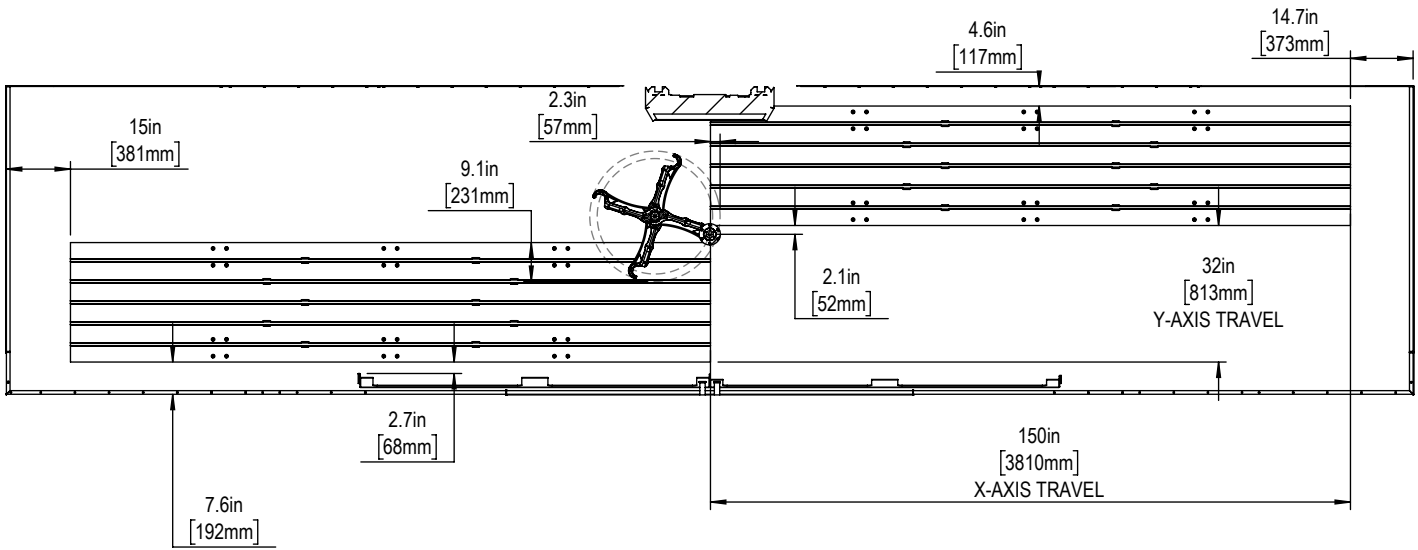

Z-AXIS TRAVEL & CLEARANCE

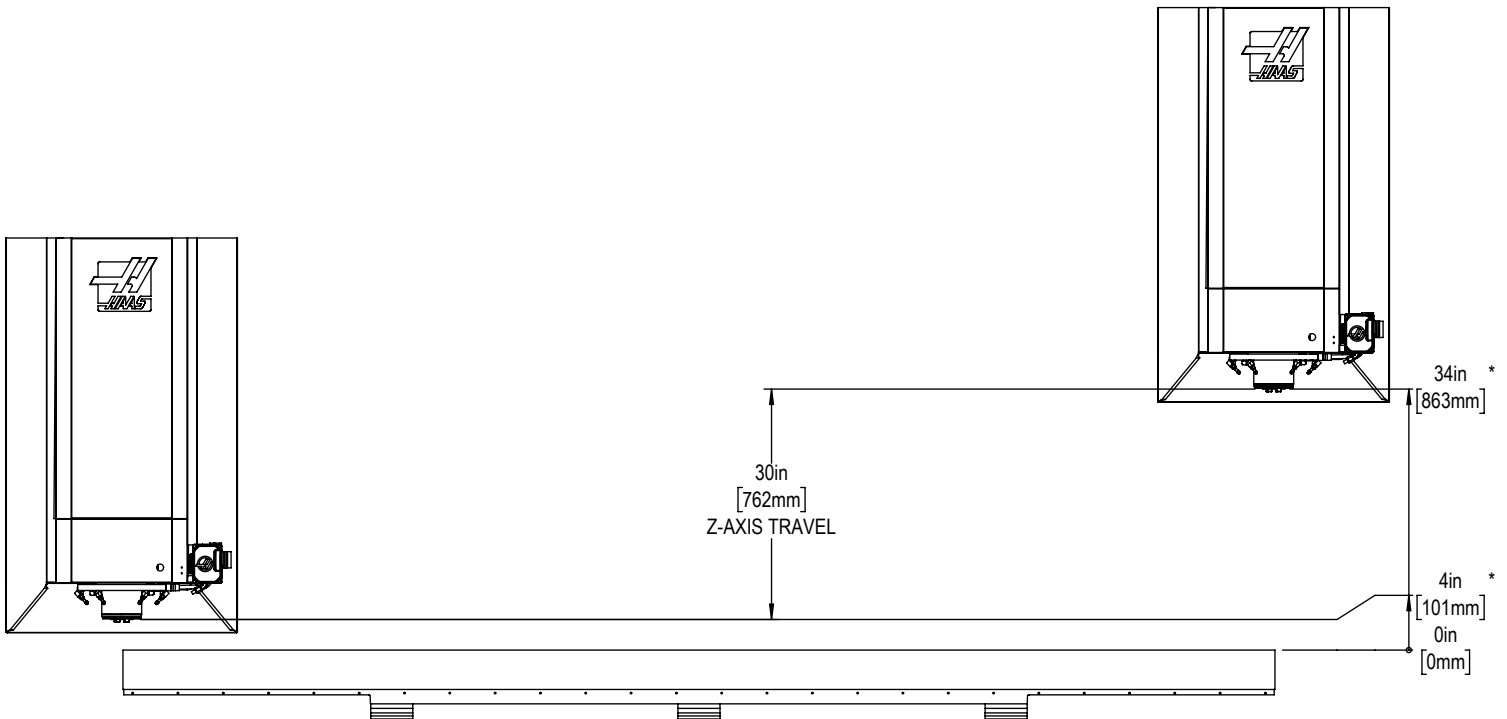

Table

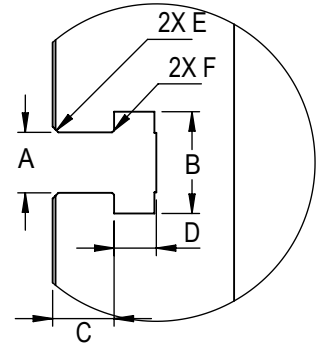
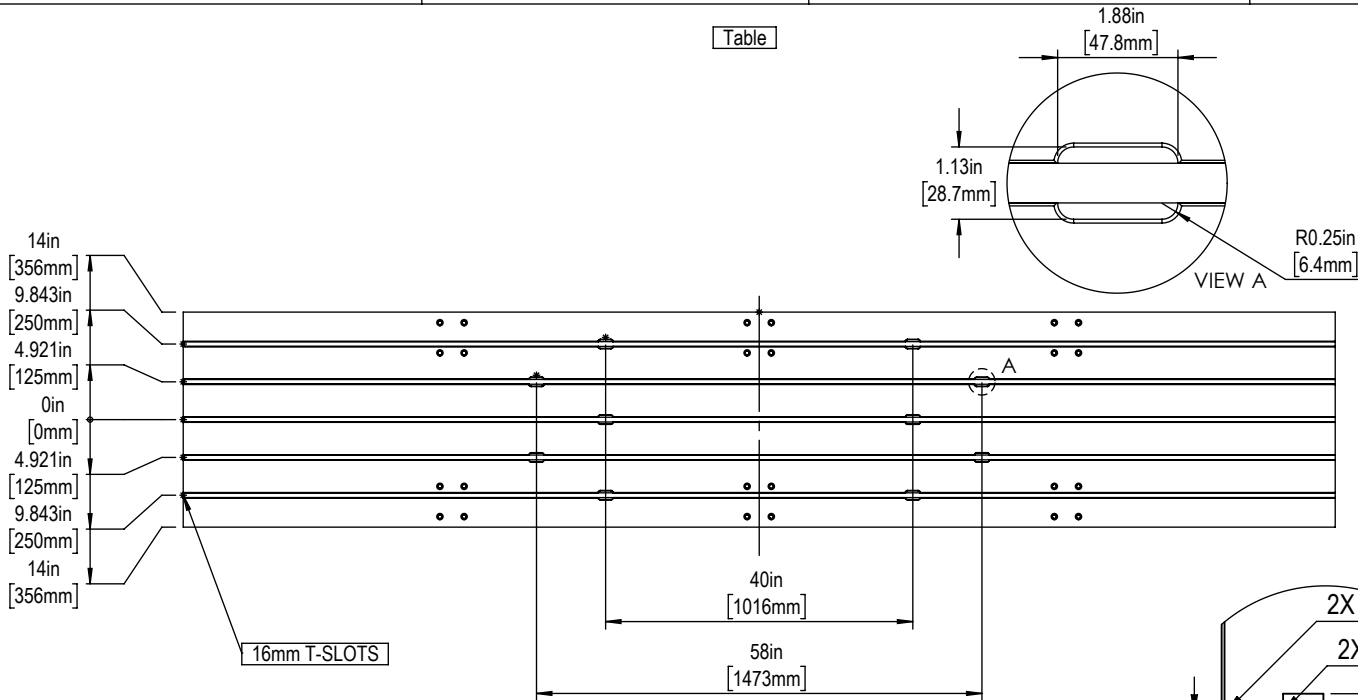

T-Slot Dimensions in inches

Slot Size	A	B	C	D	E	F
12mm	$0.438^{+0.002}_{-0.000}$	0.76 ± 0.02	0.310 ± 0.010	0.318 ± 0.010	$0.03 \times 45^\circ$	$0.020 \times 45^\circ$
16mm	0.628 ± 0.002	1.06 ± 0.02	0.640 ± 0.010	0.420 ± 0.010	$0.06 \times 45^\circ$	$0.020 \times 45^\circ$

Tool Changer

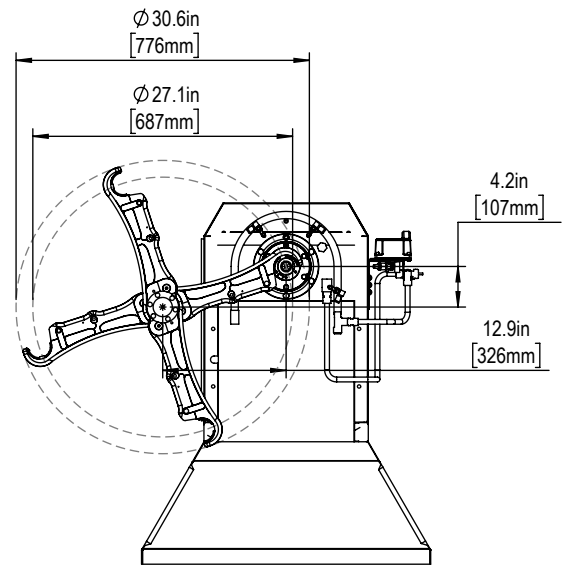
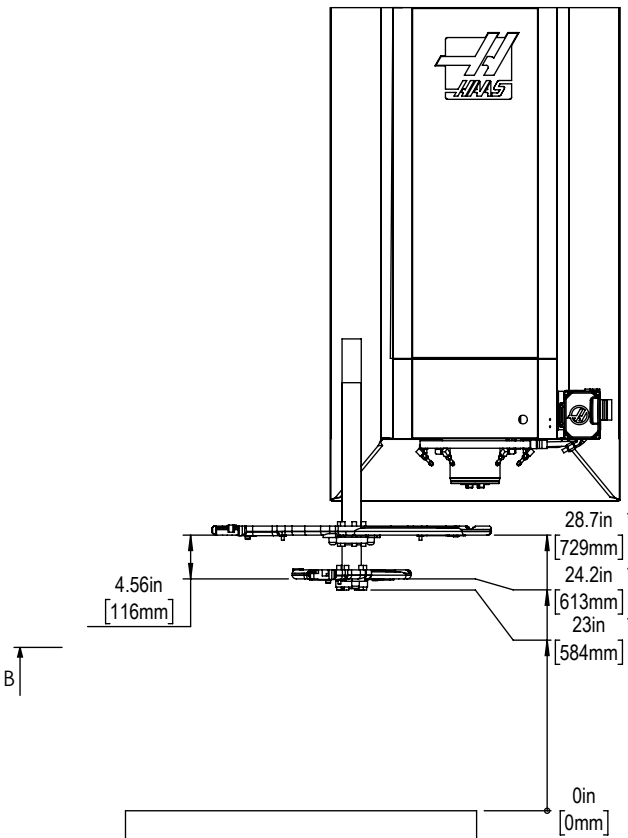

SECTION B-B